



eleva



LED products for street, industrial,  
and large areas lighting



---

ELEVA PRICELIST

---

**2014**





---

ELEVA PRICELIST

---

**2014**

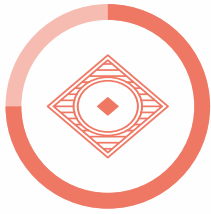

Niteko.  
Enjoy the light.

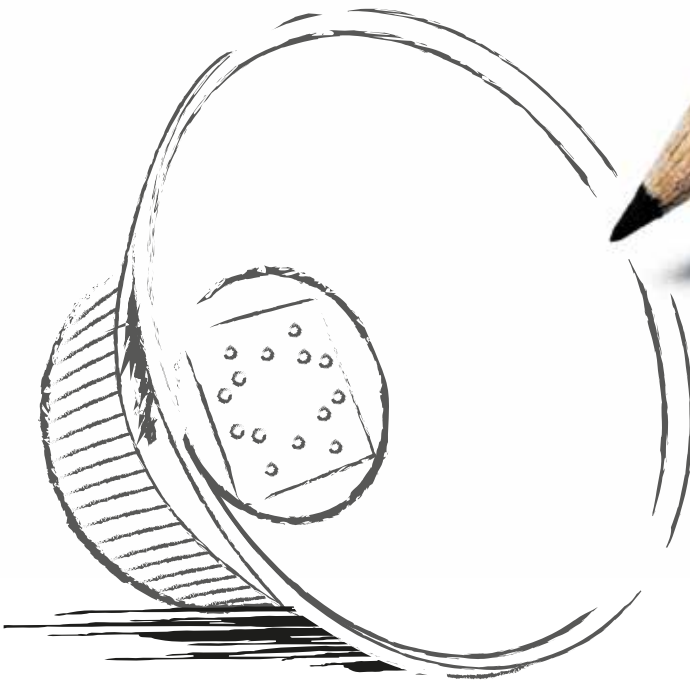

RoHS





LED products for street, industrial,  
large areas and indoor lighting



Urano	Pag. 4
Urano RGB	Pag. 6
Halley	Pag. 8
Futura	Pag. 10
Guida	Pag. 12
Zenith	Pag. 14
Victoria	Pag. 14
Urban Kit	Pag. 16

### Code composition

<b>[N]</b>	<b>[Modello]</b>	<b>[I]</b>	<b>-</b>	<b>[K]</b>	<b>[°°]</b>	<b>-</b>	<b>[*]</b>
PRODUCT SERIES	PRODUCT MODEL	POWER SUPPLY	BANK LINE	COLOR TEMPERATURE	OPTICS	BANK LINE	FRAME COLOR

Example on Urano fixture:

<b>U</b>	<b>24</b>	<b>H</b>	<b>-</b>	<b>N</b>	<b>A1</b>	<b>-</b>	<b>GR</b>
----------	-----------	----------	----------	----------	-----------	----------	-----------

To create CODE is needed to change field: **[N][Modello][I]-[K][°°]-[\*]** with optional codes available on different products legend.

ELEVA PRICELIST

**2014**

# Urano



Made in Italy



# Urano | RGB



Made in Italy





Code	Actual Power System	Rated Luminous Flux (T <sub>j</sub> = 85°C)	LED No.	LED Kind	LED Power supply (If)	Correlate colour temperature (CCT)	Size (LxDxH); Weight;	Price list
U24L-[K]00-[*]	24 W	3.180 lm	6	Quadrichip	350 mA	4.000K / 5.000K	404x416x112 mm; 8,0 kg	€ 470,00
U24L-W00-[*]	24 W	2.860 lm	6	Quadrichip	350 mA	3.000K	404x416x112 mm; 8,0 kg	€ 480,00
U24L-[K][°]-[*]	24 W	3.180 lm	6	Quadrichip	350 mA	4.000K / 5.000K	404x416x112 mm; 8,0 kg	€ 490,00
U24L-W[°]-[*]	24 W	2.860 lm	6	Quadrichip	350 mA	3.000K	404x416x112 mm; 8,0 kg	€ 500,00
U24M-[K]00-[*]	37 W	4.560 lm	6	Quadrichip	530 mA	4.000K / 5.000K	404x416x112 mm; 8,0 kg	€ 480,00
U24M-W00-[*]	37 W	4.100 lm	6	Quadrichip	530 mA	3.000K	404x416x112 mm; 8,0 kg	€ 490,00
U24M-[K][°]-[*]	37 W	4.560 lm	6	Quadrichip	530 mA	4.000K / 5.000K	404x416x112 mm; 8,0 kg	€ 500,00
U24M-W[°]-[*]	37 W	4.100 lm	6	Quadrichip	530 mA	3.000K	404x416x112 mm; 8,0 kg	€ 510,00
U24H-[K]00-[*]	52 W	6.000 lm	6	Quadrichip	700 mA	4.000K / 5.000K	404x416x112 mm; 8,0 kg	€ 490,00
U24H-W00-[*]	52 W	5.400 lm	6	Quadrichip	700 mA	3.000K	404x416x112 mm; 8,0 kg	€ 500,00
U24H-[K][°]-[*]	52 W	6.000 lm	6	Quadrichip	700 mA	4.000K / 5.000K	404x416x112 mm; 8,0 kg	€ 510,00
U24H-W[°]-[*]	52 W	5.400 lm	6	Quadrichip	700 mA	3.000K	404x416x112 mm; 8,0 kg	€ 520,00
U32H-[K]00-[*]	69 W	8.000 lm	8	Quadrichip	700 mA	4.000K / 5.000K	404x416x112 mm; 8,0 kg	€ 500,00
U32H-W00-[*]	69 W	7.200 lm	8	Quadrichip	700 mA	3.000K	404x416x112 mm; 8,0 kg	€ 510,00
U32H-[K][°]-[*]	69 W	8.000 lm	8	Quadrichip	700 mA	4.000K / 5.000K	404x416x112 mm; 8,0 kg	€ 530,00
U32H-W[°]-[*]	69 W	7.200 lm	8	Quadrichip	700 mA	3.000K	404x416x112 mm; 8,0 kg	€ 540,00
U48H-[K]00-[*]	104 W	12.000 lm	12	Quadrichip	700 mA	4.000K / 5.000K	404x416x112 mm; 8,0 kg	€ 540,00
U48H-W00-[*]	104 W	10.800 lm	12	Quadrichip	700 mA	3.000K	404x416x112 mm; 8,0 kg	€ 560,00
U48H-[K][°]-[*]	104 W	12.000 lm	12	Quadrichip	700 mA	4.000K / 5.000K	404x416x112 mm; 8,0 kg	€ 580,00
U48H-W[°]-[*]	104 W	10.800 lm	12	Quadrichip	700 mA	3.000K	404x416x112 mm; 8,0 kg	€ 600,00
U64H-[K]00-[*]	139 W	16.000 lm	16	Quadrichip	700 mA	4.000K / 5.000K	404x416x112 mm; 8,0 kg	€ 600,00
U64H-W00-[*]	139 W	15.840 lm	16	Quadrichip	700 mA	3.000K	404x416x112 mm; 8,0 kg	€ 620,00
U64H-[K][°]-[*]	139 W	16.000 lm	16	Quadrichip	700 mA	4.000K / 5.000K	404x416x112 mm; 8,0 kg	€ 650,00
U64H-W[°]-[*]	139 W	15.840 lm	16	Quadrichip	700 mA	3.000K	404x416x112 mm; 8,0 kg	€ 670,00
U80H-[K]00-[*]	174 W	20.000 lm	20	Quadrichip	700 mA	4.000K / 5.000K	554x416x112 mm; 15,0kg	€ 860,00
U80H-W00-[*]	174 W	18.000 lm	20	Quadrichip	700 mA	3.000K	554x416x112 mm; 15,0 kg	€ 890,00
U80H-[K][°]-[*]	174 W	20.000 lm	20	Quadrichip	700 mA	4.000K / 5.000K	554x416x112 mm; 15,0kg	€ 920,00
U80H-W[°]-[*]	174 W	18.000 lm	20	Quadrichip	700 mA	3.000K	554x416x112 mm; 15,0 kg	€ 950,00
U96H-[K]00-[*]	208 W	24.000 lm	24	Quadrichip	700 mA	4.000K / 5.000K	554x416x112 mm; 15,0kg	€ 890,00
U96H-W00-[*]	208 W	21.600 lm	24	Quadrichip	700 mA	3.000K	554x416x112 mm; 15,0 kg	€ 920,00
U96H-[K][°]-[*]	208 W	24.000 lm	24	Quadrichip	700 mA	4.000K / 5.000K	554x416x112 mm; 15,0kg	€ 970,00
U96H-W[°]-[*]	208 W	21.600 lm	24	Quadrichip	700 mA	3.000K	554x416x112 mm; 15,0 kg	€ 1.000,00
U104H-[K]00-[*]	225 W	26.000 lm	26	Quadrichip	700 mA	4.000K / 5.000K	554x416x112 mm; 15,0kg	€ 940,00
U104H-W00-[*]	225 W	23.400 lm	26	Quadrichip	700 mA	3.000K	554x416x112 mm; 15,0 kg	€ 970,00
U104H-[K][°]-[*]	225 W	26.000 lm	26	Quadrichip	700 mA	4.000K / 5.000K	554x416x112 mm; 15,0kg	€ 1.020,00
U104H-W[°]-[*]	225 W	23.400 lm	26	Quadrichip	700 mA	3.000K	554x416x112 mm; 15,0 kg	€ 1.050,00
U120H-[K]00-[*]	260 W	30.000 lm	30	Quadrichip	700 mA	4.000K / 5.000K	754x416x112 mm; 17,0 kg	€ 1.050,00
U120H-W00-[*]	260 W	27.000 lm	30	Quadrichip	700 mA	3.000K	754x416x112 mm; 17,0 kg	€ 1.090,00
U120H-[K][°]-[*]	260 W	30.000 lm	30	Quadrichip	700 mA	4.000K / 5.000K	754x416x112 mm; 17,0 kg	€ 1.150,00
U120H-W[°]-[*]	260 W	27.000 lm	30	Quadrichip	700 mA	3.000K	754x416x112 mm; 17,0 kg	€ 1.190,00
U144H-[K]00-[*]	313 W	36.000 lm	36	Quadrichip	700 mA	4.000K / 5.000K	754x416x112 mm; 17,0 kg	€ 1.120,00
U144H-W00-[*]	313 W	32.400 lm	36	Quadrichip	700 mA	3.000K	754x416x112 mm; 17,0 kg	€ 1.170,00
U144H-[K][°]-[*]	313 W	36.000 lm	36	Quadrichip	700 mA	4.000K / 5.000K	754x416x112 mm; 17,0 kg	€ 1.240,00
U144H-W[°]-[*]	313 W	32.400 lm	36	Quadrichip	700 mA	3.000K	754x416x112 mm; 17,0 kg	€ 1.290,00

#### Code Composition

[K] = N (4.000K ± 300K) - C (5.000K ± 300K) - W (3.000K ± 300K)

[°] = 00 (115°) - 80 (80°) - 56 (56°) - 30 (30°) - 16 (16°) - E1 (100°x23°) - E2 (37°x21°) - A1 (138°x50°) - A3 (132°x60°) - R1 (154°)

[\*] = GR (Body: Anodized Grey / Caps: RAL 7035) - NE (Body: Black Satin / Caps: RAL 7024) - FS (Body: Smokey grey satin / Caps: RAL 7024)

# Urano | RGB

Code	Actual Power System	Rated Luminous Flux (Tj = 85°C)	LED No.	LED Kind	LED Power supply (If)	Correlate colour temperature (CCT)	Size (LxDxH); Weight;	Price list
U12L-RGBW00-[*]	60 W	2.200 lm	12	R-G-B-W	350 mA	Multicolore	404x416x112 mm; 8,0 kg	€ 1.050,00
U12L-RGBW[°°]-[*]	60 W	2.200 lm	12	R-G-B-W	350 mA	Multicolore	404x416x112 mm; 8,0 kg	€ 1.100,00
U12M-RGBW00-[*]	86 W	3.000 lm	12	R-G-B-W	530 mA	Multicolore	404x416x112 mm; 8,0 kg	€ 1.150,00
U12M-RGBW[°°]-[*]	86 W	3.000 lm	12	R-G-B-W	530 mA	Multicolore	404x416x112 mm; 8,0 kg	€ 1.200,00
U12H-RGBW00-[*]	127 W	3.800 lm	12	R-G-B-W	700 mA	Multicolore	404x416x112 mm; 8,0 kg	€ 1.250,00
U12H-RGBW[°°]-[*]	127 W	3.800 lm	12	R-G-B-W	700 mA	Multicolore	404x416x112 mm; 8,0 kg	€ 1.300,00

## Code Composition

[°°] = 00 (115°) - 80 (80°) - 56 (56°) - 30 (30°) - 16 (16°) - E1 (100°x23°) - E2 (37°x21°)

[\*] = GR (Body: Anodized Grey / Caps: RAL 7035) - NE (Body: Black Satin / Caps: RAL 7024) - FS (Body: Smokey grey satin / Caps: RAL 7024)

# Urano & Urano | RGB

## Size (LxDxH); Weight; Package Quantity

PRIMARY PACKAGE: (U12 - U24 - U32 - U48 - U64): 530 x 460 x 130 mm; 9,0 kg; 1pz./Scatola

TERTIARY PACKAGE : (U12 - U24 - U32 - U48 - U64): 1.200 x 800 x 165 mm; 200,0 kg; 21pz./Pallet

PRIMARY PACKAGE: (U80 - U96 - U104): 680 x 460 x 130 mm; 16,0 kg; 1pz./Scatola

TERTIARY PACKAGE : (U80 - U96 - U104): 1.200 x 800 x 165 mm; 300,0 kg; 18pz./Pallet

PRIMARY PACKAGE: (U120 - U144): 800 x 460 x 130 mm; 18,0 kg; 1pz./Scatola

TERTIARY PACKAGE : (U120 - U144): 1.200 x 800 x 165 mm; 230 kg; 12z./Pallet

# Urano & Urano | RGB

## OPTIONAL COLORS



### [GR]

C: Anodized Grey • T: Grey RAL 7035



### [NE]

C: Black Satin • T: Anthracite Grey RAL 7024



### [FS]

C: Smokey Grey Satin • T: Anthracite Grey RAL 7024

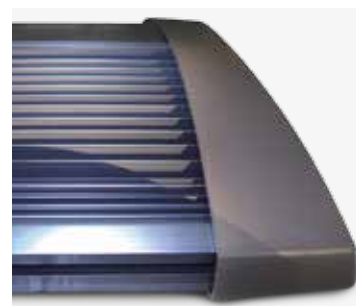

# Urano e Urano | RGB

## MOUNTING ACCESSORIES

- Adjustable architectural bracket (KM-U-AR) standard equipment
- other accessories supplied on demand



### KM-U-AR

Wall mounting (standard)



### KM-U-GAL

Raceway mounting (tunnel)



### KM-U-SPS

Suspension mounting



### KM-U-TP

Pole mounting



### KM-U-TES

Extended cable mounting



### KM-U-INC

Recessed mounting



### KM-U-BAS

Artistic arm mounting



### KM-U-TP2

Single arm mounting



### KM-U-PLF

Ceiling



## Mounting accessories

Accessories	Description	Price
KM-U-AR	Adjustable architectural bracket (AISI 304 Steel) <b>(in standard equipment)</b>	standard equipment
KM-U-TP	Adjustable head pole bracket varnished galvanized sheet steel grey	€ 20,00
KM-U-TP2	Fixed bracket for arm mounting varnished galvanized steel	€ 75,00
KM-U-PLF	Adjustable bracket for ceiling mounting (AISI 304 Steel)	€ 20,00
KM-U-INC	Recessed mounting Kit for false ceiling galvanized steel varnished sheet steel gray (suspension)	€ 35,00
KM-U-SPS	Suspension mounting kit with 2 hooks AISI 304 Steel	€ 20,00
KM-U-TES	Suspension mounting kit extended cable AISI 304 Steel	€ 210,00
KM-U-GAL	Fixed bracket mounting su canalina metallic cable AISI 304 Steel	€ 50,00
KM-U-BAS	Single artistic arm for head pole mounting varnished galvanized sheet steel gray	€ 200,00

## Kit & Optional

Kit & Optional	Description	Price
KU-12V	(I)12V d.c. Power Supply for photovoltaic applications	€ 75,00
KU-24V	(I)24V d.c. Power Supply for photovoltaic applications	€ 75,00
KU-EM	Stand-alone kit for emergency lighting (4 LED - 100mA - 5W - 600lm - Autonomy 1h)	€ 200,00
KU-SPD	Overvoltage Safety device (10kV)	€ 25,00
KU-D/S1	(II)No dazzling PMMA etched screen replacing 4mm tempered glass	€ 20,00
KU-D/S2	(III)No dazzling PMMA etched screen replacing 4mm tempered glass	€ 40,00
KU-D/S3	(IV)No dazzling PMMA etched screen replacing 4mm tempered glass	€ 55,00
KU-DIM1	(II) 1-10V analog signal dimmable power section (Quadripolar cable )	€ 15,00
KU-DIM2	(V)1-10V analog signal dimmable power section (Quadripolar cable )	€ 40,00
KU-DALI1	(II) dimmable power section with DALI digital signal (quadripolar cable)	€ 55,00
KU-DALI2	(V) dimmable power section with DALI digital signal (quadripolar cable)	€ 120,00
KU-PRG1	(II)5 operation options pre programmed power section	€ 55,00
KU-PRG2	(V)5 operation options pre programmed power section	€ 120,00
KU-PLV1	(II) dimmable power section with parallel interface	€ 75,00
KU-PLV2	(V) dimmable power section with parallel interface	€ 150,00
KU-LPL	1-10V analog signal dimmable power section with bidirectional LPL module	€ 130,00
KU-TVCC	Built in camera for TVCC video monitoring systems interface	€ 600,00
Uxxxx-[K][°]-GR	GR = standard colour: BODY anodized grey / Caps grey RAL 7035	€ -
Uxxxx-[K][°]-NE	NE = Optional Colour: BODY nero satin / Caps charcoal RAL 7024 - MOQ. 50 pcs	€ 70,00
Uxxxx-[K][°]-FS	FS = Optional Colour: BODY smokey satin / Caps charcoal RAL 7024 - MOQ. 50pcs	€ 70,00

## \* Compatible Models

- (I) = U24 Models
- (II) = U24 - U32 - U48 - U64 Models
- (III) = U80 - U96 - U104 Models
- (IV) = U120 - U144 Models
- (V) = U80 - U96 - U104 - U120 - U144 Models



# Halley

  
Made in Italy

  
GHOST-R



YEARS WARRANTY  
**5**



Code	Actual Power System	Rated luminous flux (Tj = 85°C)	LED No.	LED Kind	LED Power supply (If)	Correlate colour temperature (CCT)	Size (ØxH); Weight;	Price List
HALLEY-10H-[K][°]-GR	86 W	10.000 lm	10	Quadrichip	700 mA	4.000K / 5.000K	Ø508x422 mm; 8,0 kg	€ 500,00
HALLEY-10H-W[°]-GR	86 W	9.000 lm	10	Quadrichip	700 mA	3.000K	Ø508x422 mm; 8,0 kg	€ 550,00
HALLEY-16H-[K][°]0-GR	135 W	16.000 lm	16	Quadrichip	700 mA	4.000K / 5.000K	Ø508x422 mm; 8,0 kg	€ 640,00
HALLEY-16H-W[°]-GR	135 W	14.400 lm	16	Quadrichip	700 mA	3.000K	Ø508x422 mm; 8,0 kg	€ 700,00
HALLEY-22H-[K][°]-GR	188 W	22.000 lm	22	Quadrichip	700 mA	4.000K / 5.000K	Ø508x422 mm; 8,0 kg	€ 780,00
HALLEY-22H-W[°]-GR	188 W	19.800 lm	22	Quadrichip	700 mA	3.000K	Ø508x422 mm; 8,0 kg	€ 850,00
HALLEY-24X-[K][°]-GR	250 W	30.000 lm	24	Quadrichip	850 mA	4.000K / 5.000K	Ø508x422 mm; 8,0 kg	€ 880,00
HALLEY-24X-W[°]-GR	250 W	27.000 lm	24	Quadrichip	850 mA	3.000K	Ø508x422 mm; 8,0 kg	€ 950,00

#### Code Composition

[K] = N (4.000K ± 300K) - C (5.000K ± 300K) - W (3.000K ± 300K)

[°] = 90 (90°) - 00 (115° - only on version without reflector)

#### Size (LxPxH); Weight; Package Quantity

PRIMARY PACKAGE : 335 x 335 x 235 mm; 9,5 kg; 1pc./package

TERTIARY PACKAGE: 1.200 x 800 x 165 mm; 290,0 kg; 30 pcs/Pallet

#### MOUNTING ACCESSORIES

- Recessed mounting



#### KM-H-INC

Recessed mounting Kit

This mounting kit is particularly suitable in case of false ceiling.  
(Example: airport, service station, industrial structures)

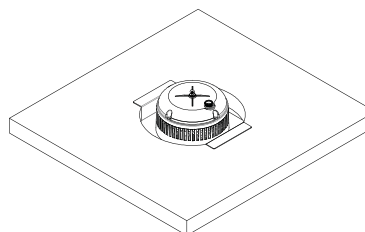

#### ADDITIONAL ACCESSORIES

- Transparent tempered glass
- PMMA transparent or frosted (optional) screen



#### KH-V/C

Transparent tempered glass

#### KH-V/S

Frosted PMMA screen

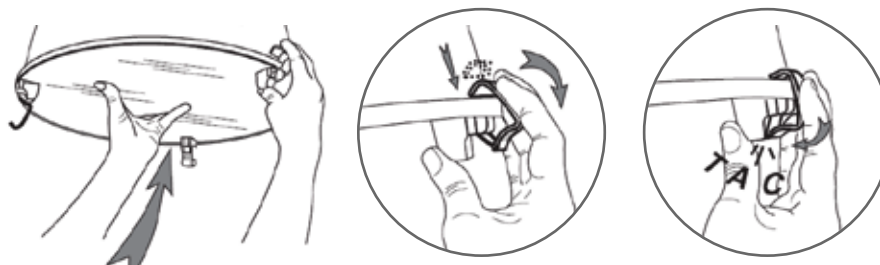

#### Kit, Optional & Mounting accessories

KM-H-INC	Recessed mounting Kit for false ceiling galvanized steel varnished sheet steel gray (without reflector)	€ 55,00
KH-V/C	5mm transparent tempered glass with clamps and safety chain	€ 50,00
KH-D/S	No dazzling PMMA etched Diffusor replacing transparent PMMA Standard equipment	€ 20,00
KH-EM	Stand-alone kit for emergency lighting (4 LED - 100mA - 5W - 600lm - Autonomy 1h)	€ 225,00
KH-SPD	Overvoltage Safety device (10kV)	€ 25,00
KH-DIM	1-10V analog signal dimmable power section (Quadripolar cable)	€ 15,00
KH-DALI	dimmable power section with DALI digital signal (quadripolar cable)	€ 15,00

# Futura



#### MOUNTING ACCESSORIES

- Optional mounting on head-pole



#### KM-F-TP

Fixed head-pole

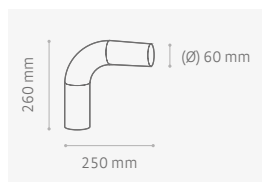

#### KM-F-OR

Adjustable head-pole

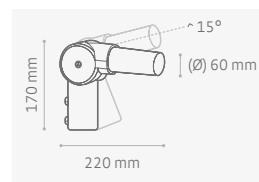



Code	Actual Power System	Rated luminous flux (Tj = 85°C)	LED No.	LED kind	LED Power supply (If)	Correlate colour temperature (CCT)	Size (LxPxH); Weight;	Price List
F24L-[K]01-AN	26 W	3.135 lm	24	Monochip	350 mA	4.000K / 5.000K	730x157x288 mm; 10,5 kg	€ 640,00
F24L-W01-AN	26 W	2.820 lm	24	Monochip	350 mA	3.000K	730x157x288 mm; 10,5 kg	€ 670,00
F24M-[K]01-AN	41 W	4.420 lm	24	Monochip	530 mA	4.000K / 5.000K	730x157x288 mm; 10,5 kg	€ 670,00
F24M-W01-AN	41 W	3.720 lm	24	Monochip	530 mA	3.000K	730x157x288 mm; 10,5 kg	€ 700,00
F24H-[K]01-AN	56 W	5.570 lm	24	Monochip	700 mA	4.000K / 5.000K	730x157x288 mm; 10,5 kg	€ 700,00
F24H-W01-AN	56 W	4.680 lm	24	Monochip	700 mA	3.000K	730x157x288 mm; 10,5 kg	€ 730,00
F36M-[K]01-AN	61 W	6.700 lm	36	Monochip	530 mA	4.000K / 5.000K	730x157x288 mm; 10,5 kg	€ 770,00
F36M-W01-AN	61 W	6.030 lm	36	Monochip	530 mA	3.000K	730x157x288 mm; 10,5 kg	€ 800,00
F36H-[K]01-AN	83 W	8.350 lm	36	Monochip	700 mA	4.000K / 5.000K	730x157x288 mm; 10,5 kg	€ 800,00
F36H-W01-AN	83 W	7.515 lm	36	Monochip	700 mA	3.000K	730x157x288 mm; 10,5 kg	€ 830,00
F43M-[K]01-AN	73 W	7.920 lm	43	Monochip	530 mA	4.000K / 5.000K	730x157x288 mm; 10,5 kg	€ 860,00
F43M-W01-AN	73 W	7.130 lm	43	Monochip	530 mA	3.000K	730x157x288 mm; 10,5 kg	€ 900,00
F43H-[K]01-AN	100 W	9.980 lm	43	Monochip	700 mA	4.000K / 5.000K	730x157x288 mm; 10,5 kg	€ 890,00
F43H-W01-AN	100 W	8.980 lm	43	Monochip	700 mA	3.000K	730x157x288 mm; 10,5 kg	€ 940,00
F52M-[K]01-AN	88 W	9.580 lm	52	Monochip	530 mA	4.000K / 5.000K	730x157x288 mm; 10,5 kg	€ 950,00
F52M-W01-AN	88 W	8.620 lm	52	Monochip	530 mA	3.000K	730x157x288 mm; 10,5 kg	€ 1.000,00
F52H-[K]01-AN	120 W	12.080 lm	52	Monochip	700 mA	4.000K / 5.000K	730x157x288 mm; 10,5 kg	€ 990,00
F52H-W01-AN	120 W	10.870 lm	52	Monochip	700 mA	3.000K	730x157x288 mm; 10,5 kg	€ 1.100,00
F60M-[K]01-AN	101 W	11.000 lm	60	Monochip	530 mA	4.000K / 5.000K	730x157x288 mm; 10,5 kg	€ 1.090,00
F60M-W01-AN	101 W	9.900 lm	60	Monochip	530 mA	3.000K	730x157x288 mm; 10,5 kg	€ 1.150,00
F60H-[K]01-AN	140 W	13.910 lm	60	Monochip	700 mA	4.000K / 5.000K	730x157x288 mm; 10,5 kg	€ 1.120,00
F60H-W01-AN	140 W	12.520 lm	60	Monochip	700 mA	3.000K	730x157x288 mm; 10,5 kg	€ 1.200,00
F68L-[K]01-AN	74 W	8.890 lm	68	Monochip	350 mA	4.000K / 5.000K	730x157x288 mm; 10,5 kg	€ 1.190,00
F68L-W01-AN	74 W	8.000 lm	68	Monochip	350 mA	3.000K	730x157x288 mm; 10,5 kg	€ 1.270,00
F68H-[K]01-AN	157 W	15.800 lm	68	Monochip	700 mA	4.000K / 5.000K	730x157x288 mm; 10,5 kg	€ 1.250,00
F68H-W01-AN	157 W	14.220 lm	68	Monochip	700 mA	3.000K	730x157x288 mm; 10,5 kg	€ 1.330,00

#### Code Composition

[K] = N (4.000K ± 300K) - C (5.000K ± 300K) - W (3.000K ± 300K)

#### Size (LxPxH); Weight; Package Quantity

PRIMARY PACKAGE: 795 x 350 x 205 mm; 11,0 kg; 1pc./Package

TERTIARY PACKAGE: 1.200 x 800 x 165 mm; 180,0 kg; 15pcs/Pallet

#### Kit, Optional e Mounting accessories

KM-F-TP	90° fixed bracket for head pole mounting varnished galvanized steel	€ 50,00
KM-F-OR	±15° Adjustable bracket for arm mounting (180°) or head - pole (90°) varnished galvanized steel	€ 85,00
KF-12V	(I)12V d.c. power section for photovoltaic applications	€ 150,00
KF-24V	(I) 24V d.c. power section for photovoltaic applications	€ 100,00
KF-SPD	Overvoltage Safety device (10kV)	€ 25,00
KF-DIM	1-10V analog signal dimmable power section (Quadripolar cable )	€ 15,00
KF-DALI	dimmable power section with DALI digital signal (quadripolar cable)	€ 15,00
KF-PRG	5 operation options pre programmed power section	€ 55,00
KF-PLV	in tensione dimmable power section with parallel interface	€ 75,00
KF-LPL	1-10V analog signal dimmable power section with bidirectional LPL module	€ 130,00
Fxxx-[K]01-AN	AN = standard colour: Charcoal RAL 7024	€ -
Fxxx-[K]01-[*]	* = Other colours available on demand - MOQ 50 pcs	€ 55,00

#### \* Compatible Models

(I) = F24 Models

# Guida

  
Made in Italy



YEARS WARRANTY  
**5**



Code	Actual Power System	Rated luminous flux (Tj = 85°C)	LED No.	LED kind	LED Power supply (If)	Correlate colour temperature (CCT)	Size (LxPxH); Weight;	Price List
G3H-[K]A1-[*]	27 W	3.000 lm	3	Quadrichip	700 mA	4.000K / 5.000K	620x290x152 mm; 8,0 kg	€ 315,00
G3H-WA1-[*]	27 W	2.700 lm	3	Quadrichip	700 mA	3.000K	620x290x152 mm; 8,0 kg	€ 330,00
G4H-[K]A1-[*]	35 W	4.000 lm	4	Quadrichip	700 mA	4.000K / 5.000K	620x290x152 mm; 8,0 kg	€ 360,00
G4H-WA1-[*]	35 W	3.600 lm	4	Quadrichip	700 mA	3.000K	620x290x152 mm; 8,0 kg	€ 380,00
G5H-[K]A1-[*]	45 W	5.000 lm	5	Quadrichip	700 mA	4.000K / 5.000K	620x290x152 mm; 8,0 kg	€ 370,00
G5H-WA1-[*]	45 W	4.500 lm	5	Quadrichip	700 mA	3.000K	620x290x152 mm; 8,0 kg	€ 390,00
G6H-[K]A1-[*]	54 W	6.000 lm	6	Quadrichip	700 mA	4.000K / 5.000K	620x290x152 mm; 8,0 kg	€ 380,00
G6H-WA1-[*]	54 W	5.400 lm	6	Quadrichip	700 mA	3.000K	620x290x152 mm; 8,0 kg	€ 400,00
G7H-[K]A1-[*]	63 W	7.000 lm	7	Quadrichip	700 mA	4.000K / 5.000K	620x290x152 mm; 8,0 kg	€ 450,00
G7H-WA1-[*]	63 W	6.300 lm	7	Quadrichip	700 mA	3.000K	620x290x152 mm; 8,0 kg	€ 470,00
G8H-[K]A1-[*]	72 W	8.000 lm	8	Quadrichip	700 mA	4.000K / 5.000K	620x290x152 mm; 8,0 kg	€ 460,00
G8H-WA1-[*]	72 W	7.200 lm	8	Quadrichip	700 mA	3.000K	620x290x152 mm; 8,0 kg	€ 490,00
G9H-[K]A1-[*]	81 W	9.000 lm	9	Quadrichip	700 mA	4.000K / 5.000K	620x290x152 mm; 8,0 kg	€ 470,00
G9H-WA1-[*]	81 W	8.100 lm	9	Quadrichip	700 mA	3.000K	620x290x152 mm; 8,0 kg	€ 500,00

#### Code Composition

[K] = N (4.000K ± 300K) - C (5.000K ± 300K) - W (3.000K ± 300K)

[\*] = AN (standard colour charcoal RAL 7024) - GR (Optional grey colour RAL 7035)

#### Size (LxPxH); Weight; Package Quantity

PRIMARY PACKAGE: 630 x 310 x 180 mm; 9,0 kg; 1 pc/Package

TERTIARY PACKAGE: 1.200 x 800 x 165 mm; 300,0 kg; 33 pcs/Pallet

#### OTHER APPLICATION

- Photovoltaic



#### KG-12V

Power supply 12V d.c.

#### KG-24V

Power supply 24V d.c.



#### Kit & Optional

KG-12V	(I)12V d.c. power section for photovoltaic applications	€ 150,00
KG-24V	(I) 24V d.c. power section for photovoltaic applications	€ 100,00
KG-SPD	Overvoltage Safety device (10kV)	€ 25,00
KG-DIM	1-10V analog signal dimmable power section (Quadripolar cable)	€ 15,00
KG-DALI	dimmable power section with DALI digital signal (quadripolar cable)	€ 55,00
KG-PRG	5 operation options pre programmed power section	€ 55,00
KG-PLV	in tensione dimmable power section with parallel interface	€ 75,00
KG-LPL	1-10V analog signal dimmable power section with bidirectional LPL module	€ 130,00
Gxx-[K]A1-AN	AN = standard colour: Charcoal RAL 7024	€ -
Gxx-[K]A1-GR	GR = Optional Colour: Grey RAL 7035 - MOQ. 100pcs	€ 25,00

#### \* Compatible Models

(I) = G4 - G6 Models

# Zenith & Victoria

  
Made in Italy

  
GHOST-R



YEARS WARRANTY  
**5**



# Zenith

Code	Actual Power System	Rated luminous flux (T <sub>j</sub> = 85°C)	LED No.	LED kind	LED Power supply (If)	Correlate colour temperature (CCT)	Size (LxPxH); Weight;	Price List
Z24L-[K][°°]	24 W	3.180 lm	6	Quadrichip	350 mA	4.000K / 5.000K	425x425x760 mm; 10,5 kg	€ 470,00
Z24L-W[°°]	24 W	2.860 lm	6	Quadrichip	350 mA	3.000K	425x425x760 mm; 10,5 kg	€ 490,00
Z24M-[K][°°]	37 W	4.720 lm	6	Quadrichip	530 mA	4.000K / 5.000K	425x425x760 mm; 10,5 kg	€ 490,00
Z24M-W[°°]	37 W	4.100 lm	6	Quadrichip	530 mA	3.000K	425x425x760 mm; 10,5 kg	€ 510,00
Z24H-[K][°°]	52 W	6.000 lm	6	Quadrichip	700 mA	4.000K / 5.000K	425x425x760 mm; 10,5 kg	€ 510,00
Z24H-W[°°]	52 W	5.500 lm	6	Quadrichip	700 mA	3.000K	425x425x760 mm; 10,5 kg	€ 530,00
Z32H-[K][°°]	69 W	8.000 lm	8	Quadrichip	700 mA	4.000K / 5.000K	425x425x760 mm; 10,5 kg	€ 560,00
Z32H-W[°°]	69 W	7.200 lm	8	Quadrichip	700 mA	3.000K	425x425x760 mm; 10,5 kg	€ 590,00

### Code Composition

[K] = N (4.000K ± 300K) - C (5.000K ± 300K) - W (3.000K ± 300K)  
 [°°] = A1 (138°x50°) - R1 (154°)

### Size (LxPxH); Weight; Package Quantity

PRIMARY PACKAGE: 500 x 500 x 800 mm; 11,0 kg; 1pc./Package  
 TERTIARY PACKAGE: 1.200 x 800 x 165 mm; 70,0 kg; 6 pcs /Pallet

# Victoria

Code	Actual Power System	Rated luminous flux (T <sub>j</sub> = 85°C)	LED No.	LED kind	LED Power supply (If)	Correlate colour temperature (CCT)	(Size (ØxH); Weight;	Price List
V24L-[K][°°]	24 W	3.180 lm	6	Quadrichip	350 mA	4.000K / 5.000K	Ø530x800 mm; 13,0 kg	€ 550,00
V24L-W[°°]	24 W	2.860 lm	6	Quadrichip	350 mA	3.000K	Ø530x800 mm; 13,0 kg	€ 570,00
V24M-[K][°°]	37 W	4.720 lm	6	Quadrichip	530 mA	4.000K / 5.000K	Ø530x800 mm; 13,0 kg	€ 570,00
V24M-W[°°]	37 W	4.100 lm	6	Quadrichip	530 mA	3.000K	Ø530x800 mm; 13,0 kg	€ 590,00
V24H-[K][°°]	52 W	6.000 lm	6	Quadrichip	700 mA	4.000K / 5.000K	Ø530x800 mm; 13,0 kg	€ 590,00
V24H-W[°°]	52 W	5.400 lm	6	Quadrichip	700 mA	3.000K	Ø530x800 mm; 13,0 kg	€ 610,00
V32H-[K][°°]	69 W	8.000 lm	8	Quadrichip	700 mA	4.000K / 5.000K	Ø530x800 mm; 13,0 kg	€ 640,00
V32H-W[°°]	69 W	7.200 lm	8	Quadrichip	700 mA	3.000K	Ø530x800 mm; 13,0 kg	€ 670,00

### Code Composition

[K] = N (4.000K ± 300K) - C (5.000K ± 300K) - W (3.000K ± 300K)  
 [°°] = A1 (138°x50°) - R1 (154°)

### Size (LxPxH); Weight; Package Quantity

PRIMARY PACKAGE: 500 x 500 x 800 mm; 13,5 kg; 1 pc./Package  
 TERTIARY PACKAGE: 1.200 x 800 x 165 mm; 90,0 kg; 6pcs /Pallet



# Urban Kit



## Urban Kit

Code	Actual Power System	Rated luminous flux (T <sub>J</sub> = 85°C)	LED No.	LED kind	LED Power supply (If)	Correlate colour temperature (CCT)	Size (LxPxH); Weight;	Price List
K24L-[K][°]	24 W	3.180 lm	6	Quadrichip	350 mA	4.000K / 5.000K	230x160x40 mm; 2,5 kg	€ 310,00
K24L-W[°°]	24 W	2.860 lm	6	Quadrichip	350 mA	3.000K	230x160x40 mm; 2,5 kg	€ 320,00
K24M-[K][°°]	37 W	4.720 lm	6	Quadrichip	530 mA	4.000K / 5.000K	230x160x40 mm; 2,5 kg	€ 330,00
K24M-W[°°]	37 W	4.100 lm	6	Quadrichip	530 mA	3.000K	230x160x40 mm; 2,5 kg	€ 350,00
K24H-[K][°°]	52 W	6.000 lm	6	Quadrichip	700 mA	4.000K / 5.000K	230x160x40 mm; 2,5 kg	€ 350,00
K24H-W[°°]	52 W	5.500 lm	6	Quadrichip	700 mA	3.000K	230x160x40 mm; 2,5 kg	€ 370,00
K32H-[K][°°]	69 W	8.000 lm	8	Quadrichip	700 mA	4.000K / 5.000K	230x160x40 mm; 2,5 kg	€ 400,00
K32H-W[°°]	69 W	7.200 lm	8	Quadrichip	700 mA	3.000K	230x160x40 mm; 2,5 kg	€ 430,00

### Code Composition

[K] = N (4.000K ± 300K) - C (5.000K ± 300K) - W (3.000K ± 300K)

[°°] = A1 (138°x50°) - R1 (154°)

### Size (LxPxH); Weight; Package Quantity

PRIMARY PACKAGE: 250 x 200 x 100 mm; 3,0 kg; 1pc./Package

TERTIARY PACKAGE: 1.200 x 800 x 165 mm; 270,0 kg; 90 pcs/Pallet

## Zenith, Victoria & Urban Kit

Kit & Optional		
KA-SPD	Overvoltage Safety device (10kV)	€ 25,00
KA-DIM	1-10V analog signal dimmable power section (Quadripolar cable )	€ 15,00
KA-DALI	dimmable power section with DALI digital signal (quadripolar cable)	€ 55,00
KA-PRG	5 operation options pre programmed power section	€ 55,00
KA-PLV	in tensione dimmable power section with parallel interface	€ 75,00
KA-LPL	1-10V analog signal dimmable power section with bidirectional LPL module	€ 130,00

The logo for 'eleva' features the word in a lowercase, sans-serif font. A red curved line starts under the 'e', goes up and over the 'l', and then curves down under the 'a'.The logo for 'NITEKO' consists of a blue diamond-shaped icon with a white dot in the center, followed by the word 'NITEKO' in a bold, blue, sans-serif font. Below the name, the text 'LED COMPANY' is followed by a red dot and the phrase 'Solid State Lighting Specialist'.

**NITEKO Srl**

**Head and manufacturing Office:**

Zona P.I.P. - Viale delle Imprese, 3 - 74020 Montemesola (TA) - ITALY  
Tel. [+39] **099.567.12.19** - Fax [+39] **099.567.11.12**  
IT 02867530731

**Commercial Office :**

Via Decò e Canetta, 65 - 24068 Seriate (BG) - ITALY  
Tel.: [+39] **035.529.38.27** - Fax [+39] **099.567.11.12**

[info@niteko.com](mailto:info@niteko.com)

[www.niteko.com](http://www.niteko.com)